



23801 E. La Palma Ave., Yorba Linda, CA 92887 Ph. 714.692.8180 Fax. 714.692.5016

www.cobrausa-vtwin.com

Items Supplied >

- | | |
|--|-------------------|
| 1 - K&N® CONE AIR FILTER | 3 - FLAT WASHERS |
| 1 - HOSE CLAMP | 2- BREATHER HOSES |
| 1 - PLATED TUBE ASSEMBLY | 1 - MEDIUM O-RING |
| 1 - BILLET ADAPTER PLATE | 1 - LARGE O-RING |
| 1 - BACKING PLATE | |
| 1 - INTAKE GASKET | |
| 2 - SMALL O-RING, SILICONE | |
| 2 - BREATHER BOLT, 3/8"-16 X 1" | |
| 3 - BOLT, 1/4"-20 X 7/8", BUTTONHEAD W/ LOCK PATCH | |
| 3 - LOCK WASHER, 1/4" INTERNAL TOOTHED | |
| 3 - BOLT, 1/4"-20 X 1", BUTTONHEAD W/ LOCK PATCH | |

Application(s) >

HARLEY:
SPORTSTER

2004 - 2020

Instruction Manual >

606-0103-06

Page 1 of 2

Read all instructions carefully and completely before installing your new air intake.

1. Remove the (2) allen bolts from the center of the stock air cleaner to remove the cover. Remove the (3) bolts securing the air filter. Remove the stock (2) breather bolts from the cylinder heads. Discard the air box, air filter, hardware and seals/gaskets.
2. Place the supplied o-rings onto both supplied breather bolts. Insert the breather bolts through the openings in the supplied backing plate and begin threading into the cylinder heads. Insert the supplied gasket between the backing plate and the throttle body and line up all the holes. Then snug the breather bolts but do not fully tighten at this time.
3. Place the medium and large o-rings onto the grooves of the billet adapter plate. A small amount of grease may be needed to hold the o-rings into position. See **FIGURE 1**.

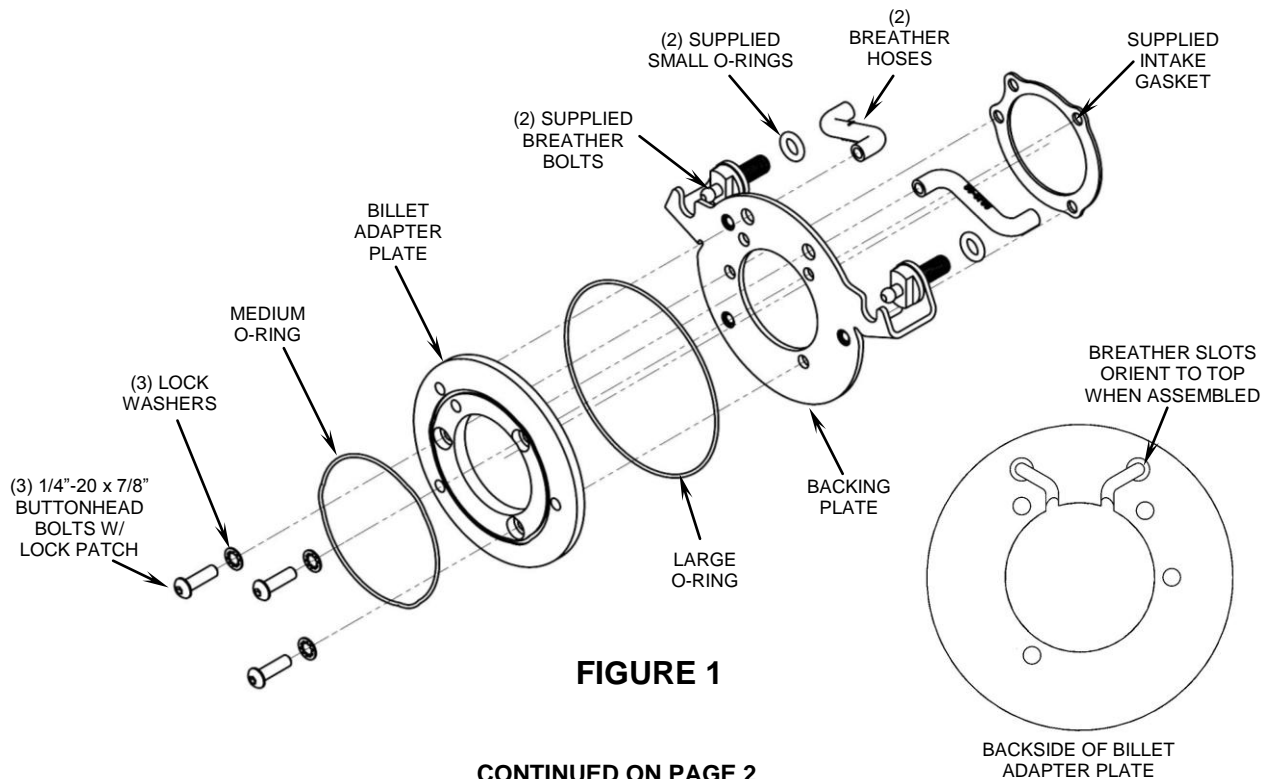

DISCLAIMER: NOT LEGAL FOR SALE OR USE IN CALIFORNIA ON ANY POLLUTION CONTROLLED MOTOR VEHICLES.

4. Align the billet adapter plate with the backing plate and throttle body and insert (3) supplied 1/4"-20 x 7/8" buttonhead bolts with lock washers through the billet adapter plate into the throttle body. Snug the bolts evenly so that the adapter plate and backing plate tighten evenly. Make sure the intake gasket is straight and that the o-ring for the adapter plate is seated properly in the groove. See **FIGURE 1**.
5. Insert the (2) supplied breather hoses through the backing plate and into the billet adapter plate with the hoses rotated outward, as shown in **FIGURE 1**. Make sure the hoses are bottomed out in the back of the billet adapter plate.
6. Once the adapter plate, backing plate, breather hoses, o-ring, and gasket are aligned properly tighten the (3) bolts evenly and then tighten the breather bolts.
7. Insert the outer ends of rubber hoses over the nipples on the breather bolts. See **FIGURE 2**.
8. Make sure the medium sized o-ring is seated properly in the groove on the billet adapter plate and then attach the tube assembly using the supplied 1/4"-20 x 1" buttonhead bolts with lock patch and the supplied flat washers. See **FIGURE 2**. Tighten the three bolts evenly.
9. Place the supplied HS-48 clamp around the rubber boot of the K&N® filter so that the clamp screw will be on the inside and facing down. Then slide the filter onto the tube as far as it will go. Align the logo on the front cover so that it is level with the ground and tighten the clamp. See **FIGURE 2**.
10. Verify all the bolts are tight and then wipe off any fingerprints with a clean microfiber cloth.

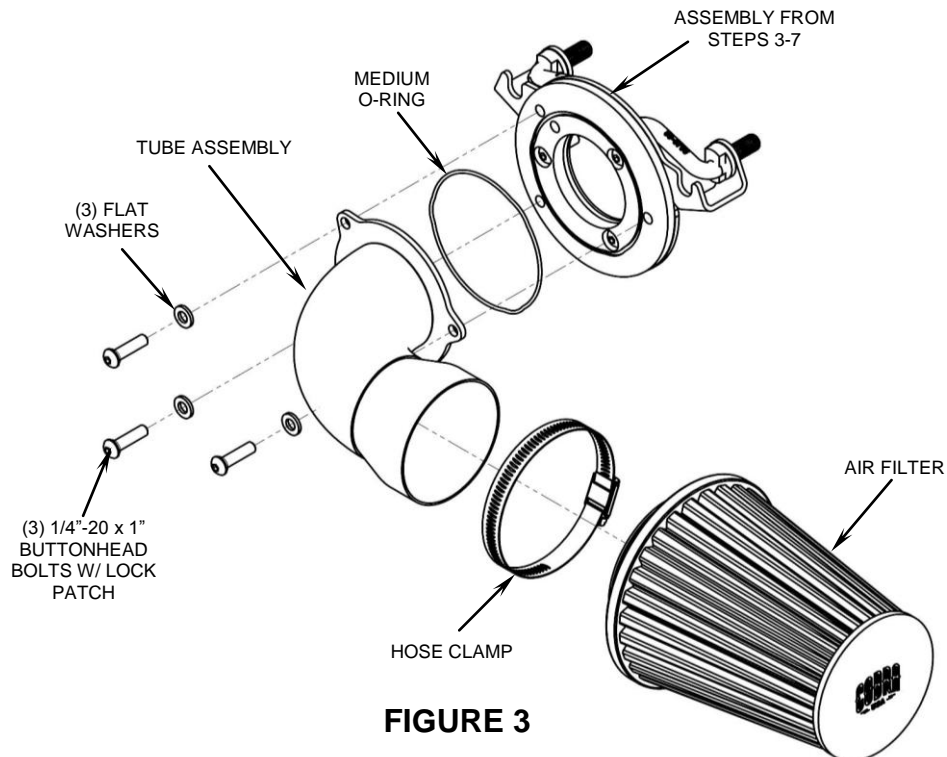

FIGURE 3

CLEANING INSTRUCTIONS: To clean any black portions of the cone air intake system use a liquid based soap detergent, such as dishwashing soap applied with a soft cloth and rinse with clean water. **Note:** Avoid abrasive cleaning methods such as granular or dry cleansers, simple green, Scotch-Brite or steel wool pads. Abrasives may breach the coating and shorten life.

DISCLAIMER: NOT LEGAL FOR SALE OR USE IN CALIFORNIA ON ANY POLLUTION CONTROLLED MOTOR VEHICLES.