

## Items Supplied >

1. 1 – Assembled Lightbar
2. 2 – M8 x 16 mm Buttonhead Allen
3. 2 – Turn Signal Adapter
4. 1 – Spot Light Switch
5. 2 – Spot Light Assembly
6. 3 – 4" Cable Ties
7. 1 – Quick Splice Connector
8. 2 – 16 Ga. Push on Wire Terminal
9. 1 – Wire 18 Gage

## Application(s) >

Kawasaki VN1600 Nomad 05-08

## Instruction Manual >

04-0442

Page 1 of 2

### Read all instructions carefully before installing your new Cobra product!

1. Position the motorcycle in an upright position and cover the front fender with clean cloth to prevent scratching the paint.
2. Remove the two phillips screws securing the headlight ring and carefully remove the headlight assembly by loosening from the bottom and lifting up at the top. Carefully disconnect the 3-prong headlight wire connector and set the headlight aside for now.
3. Locate turn signal wires inside the headlight shell and note the color-coding for reattachment later see below:

| <u>Left</u>  |              | <u>Right</u> |              |
|--------------|--------------|--------------|--------------|
| Turn signal  | Bike         | Turn signal  | Bike         |
| green        | green        | green        | gray         |
| black/yellow | black/yellow | black/yellow | black/yellow |
| blue         | red/blue     | blue         | red/blue     |

4. Carefully disconnect the turn signal wires and pull the turn signal wires out of the headlight shell.
5. Remove the two M6 x 25 mm flanged bolts and washers securing the stock turn signal bar to the lower fork clamp and remove the turn signal bar assembly. Separate the turn signal housings from the bar by removing the two large cross-point screws and the rubber grommets from the bar. Carefully pull the turn signal wires out of the bar and remove both turn signals.
6. Remove the two O - rings from the turn signal bar and place the O - rings into the groove on the supplied turn signal adaptors. Route the turn signal wires through the adaptors starting at the unthreaded end and press the adaptors fully into the turn signal housings and secure with the phillips screws.
7. Place the left turn signal wires through the inner hole in the left side of the light bar and install with the supplied M8 x 16 mm buttonhead allen bolt, see Figure 1. Position the turn signal lens forward and tighten the bolt. Note: phillips screw should face rearward. Repeat process with right turn signal.
8. Refer to Figure 1 for installation of components. Temporarily remove the four M8 button head socket bolts securing the windshield lower brackets.

\* *Cobra recommends you always wear a helmet while riding. Please never operate your motorcycle while under the influence of alcohol and/or drugs. Enjoy the new look of your motorcycle and please ride safely.*

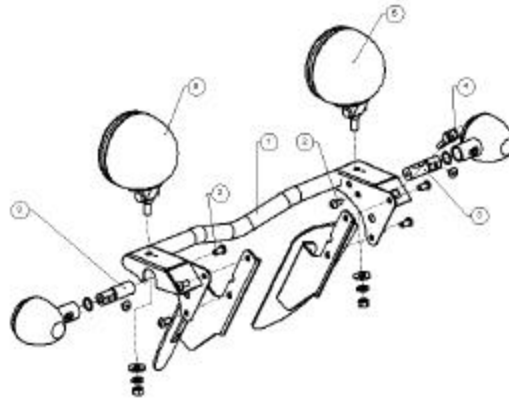

FIGURE 1: LIGHTBAR ASSEMBLY

9. It may be necessary to have additional help from someone to hold the windshield lower brackets in place while installing the light bar. Install the light bar over the top of the windshield lower brackets, center the one clearance hole in the light bar bracket over the button head bolt remaining in the fork housing, see Figure 2. Once the light bar is in place reinstall the four button head bolts and torque to 14-19 Nm (10-13.5 ft-lbs).
10. Route the turn signal wires through the hole on the inner side of the lightbar bracket and up behind the fork cover then back into the headlight shell. Route the spot light wires to the light bar switch. Twist the ends of the two spot light wires together and insert them into the supplied push-on connector and crimp with a crimping tool. Connect the push-on terminal to one of the poles on the light bar switch (it does not matter which one).
11. Feed the remaining black power wire from the other pole on the switch through the back of the headlight housing and connect to the red/blue front running light wire on the left or right turn signal wiring harness using the supplied blue quick-splice connector. Secure the external wires along the light bar with the supplied black cable ties. Trim off the excess cable tie protruding beyond the housing.
12. Plug the turn signal wires back into the correct color wires on the wiring harness and reconnect the 3-pin headlight plug onto the back of the headlight then reinstall the headlight assembly onto the headlight shell, making sure to hook the top edge first and firmly snapping the bottom edge closed. Align the mounting holes and re-secure the headlight ring with the two cross-point screws.
13. Remove one grommet and steel collar from the stock turn signal bar and replace the front brake hose guide with the grommet, collar and original 6mm screw, see Figure 3. Tighten the screw to 5.9 - 7.8 Nm (52-69 in-lbs) **Note: Inch pounds, NOT foot-pounds.**
14. Position the spotlights and tighten the pivot bolt and nut firmly. Make sure that the spotlights are not aimed too high to cause interference with oncoming vehicles. Start the motorcycle and turn on the spot light switch to check the operation of the lights. Check the turn signal operation. Periodically check the tightness of all fasteners.

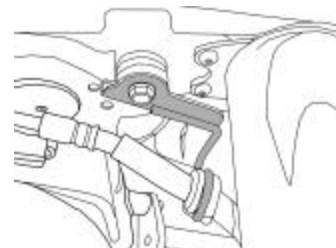

FIGURE 2: BRAKE HOSE MOUNT